



The Sizewell C Project

9.11 Responses to the ExA's First Written Questions (ExQ1) Volume 2 - Figures Part 4 of 7

Revision: 1.0

Applicable Regulation: Regulation 5(2)(o)

PINS Reference Number: EN010012

June 2021

Planning Act 2008
Infrastructure Planning (Applications: Prescribed
Forms and Procedure) Regulations 2009



CONTENTS

PART 1 OF 7

Chapter 2

- Figure 2.1 Main Development Site Boundary and Nominated Site Area for Sizewell C from NPS EN-6
- Figure 2.2 Main Development Site Main Platform Proposed General Arrangement and Nominated Site Area for Sizewell C from NPS EN-6
- Figure 2.3 Main Development Site showing the lines of Easting and Northing
- Figure 2.4 County, District, Town and Parish Councils that have made Relevant Representations
- Figure 2.5 Main Development Site Typical General Arrangement (SZC Construction)
- Figure 2.6 Main Development Site Cut Off Wall Extent, Excavation Levels and Marine Tunnelling Shafts Sheet 1 of 3
- Figure 2.7 Main Development Site Cut Off Wall Extent, Excavation Levels and Marine Tunnelling Shafts Sheet 2 of 3
- Figure 2.8 Main Development Site Cut Off Wall Extent, Excavation Levels and Marine Tunnelling Shafts Sheet 3 of 3
- Figure 2.9 Land East of Eastlands Industrial Estate Site Layout

Chapter 5

- Figure 5.1 Indicative sketch of how a potential link could be provided to link the two village bypass to a future four-village bypass

-
- Figure 5.2 A12 Four village route options (A12 Four Villages Study 2006) with the proposed Two Village Bypass route
- Figure 5.3 A12 Four Villages route options (A12 Four Villages Study 2014) with the proposed Two Village Bypass route
- Figure 5.4 A12 SEGWay Strategic Case 2017 route options with the proposed Two Village Bypass route

PART 2 OF 7

Chapter 15

- Figure 15.1 Foul water overview

Chapter 17

- Figure 17.1 Response to First Written Questions - HE 1.1
- Figure 17.2 Response to First Written Questions - HE 1.1 and HE 1.27
- Figure 17.3 Marine Historic Environment Study Area - Figure 23.1 Update
- Figure 17.4 Non-designated Heritage Records – Figure 23.2 Update
- Figure 17.5 Distribution of Deposits with High Palaeoenvironmental Potential – Figure 23.3 Update

PART 3 OF 7

Chapter 18

- Figure 18.1 Representative Viewpoints: Operational Phase Parameters Based Photowire. Key
- Figure 18.2 Representative Viewpoints: Operational Phase Parameters Based Photowire. Viewpoint 5: Footpath South of Leiston Abbey
- Figure 18.3 Representative Viewpoints: Operational Phase Parameters Based Photowire. Viewpoint 6: Suffolk Coast Path East of Goose Hill

NOT PROTECTIVELY MARKED

-
- | | |
|--------------|--|
| Figure 18.4 | Representative Viewpoints: Operational Phase Parameters Based Photowire. Viewpoint 8: Footpath North of Leiston Abbey |
| Figure 18.5 | Representative Viewpoints: Operational Phase Parameters Based Photowire. Viewpoint 9: Sizewell Gap South of Greater Gabbard Sub-Station |
| Figure 18.6 | Representative Viewpoints: Operational Phase Photowire - Year 1. Viewpoint 9: Sizewell Gap South of Greater Gabbard Sub-Station |
| Figure 18.7 | Representative Viewpoints: Operational Phase Photowire - Year 15. Viewpoint 9: Sizewell Gap South of Greater Gabbard Sub-Station |
| Figure 18.8 | Representative Viewpoints: Operational Phase Parameters Based Photowire. Viewpoint 10: Suffolk Coast Path and Sandlings Walk East of Hill Wood |
| Figure 18.9 | Representative Viewpoints: Operational Phase Photowire - Year 1. Viewpoint 10: Suffolk Coast Path and Sandlings Walk East of Hill Wood |
| Figure 18.10 | Representative Viewpoints: Operational Phase Photowire - Year 15. Viewpoint 10: Suffolk Coast Path and Sandlings Walk East of Hill Wood |
| Figure 18.11 | Representative Viewpoints: Operational Phase Parameters Based Photowire. Viewpoint 14: Suffolk Coast Path at Minsmere Sluice |
| Figure 18.12 | Representative Viewpoints: Operational Phase Parameters Based Photowire. Viewpoint 17: National Trust Dunwich Coastguard Cottages Car Park |
| Figure 18.13 | Representative Viewpoints: Operational Phase Parameters Based Photowire. Viewpoint 26: 1800m Directly East of Sizewell Power Stations |
| Figure 18.14 | Representative Viewpoints: Operational Phase Photowire - Year 1. Viewpoint 26: 1800m Directly East of Sizewell Power Stations |
-

Figure 18.15 Representative Viewpoints: Operational Phase Photowire - Year 15.
Viewpoint 26: 1800m Directly East of Sizewell Power Stations

PART 4 OF 7 (THIS PART)

- Figure 18.16 Example photographs of the finish and appearance of plinth -
Terminal 2B building at Heathrow airport
- Figure 18.17 New Bridleway Link: Landscape Retention
- Figure 18.18 New Bridleway Link: Site Clearance
- Figure 18.19 New Bridleway Link: Landscape Proposals
- Figure 18.20 Visibility of Change to Height of Operational Parameter P5
- Figure 18.21 Freight Management Facility. Representative Viewpoint 1: Existing
View
- Figure 18.22 Freight Management Facility. Representative Viewpoint 1: Photowire
- Year 1
- Figure 18.23 Freight Management Facility. Representative Viewpoint 1: Photowire
- Year 10
- Figure 18.24 Sizewell Link Road oLEMP Plate 4.1. Proposed oLEMP Habitat
Typology – Overview
- Figure 18.25 Sizewell Link Road oLEMP Plate 4.2. Proposed oLEMP Habitat
Typology – Area 1
- Figure 18.26 Sizewell Link Road oLEMP Plate 4.3. Proposed oLEMP Habitat
Typology – Area 2
- Figure 18.27 Sizewell Link Road oLEMP Plate 4.4. Proposed oLEMP Habitat
Typology – Area 3
- Figure 18.28 Sizewell Link Road oLEMP Plate 4.5. Proposed oLEMP Habitat
Typology – Area 4

- Figure 18.29 Sizewell Link Road oLEMP Plate 4.6. Proposed oLEMP Habitat Typology – Area 5
- Figure 18.30 Sizewell Link Road oLEMP Plate 4.7. Proposed oLEMP Habitat Typology – Area 6
- Figure 18.31 Sizewell Link Road oLEMP. Woodland Planting East of The East Suffolk Line
- Figure 18.32 Sizewell Link Road. Representative Viewpoint 2: Existing View
- Figure 18.33 Sizewell Link Road. Representative Viewpoint 2: Photowire

PART 5 OF 7

- Figure 18.34 Sizewell Link Road. Representative Viewpoint 3: Existing View
- Figure 18.35 Sizewell Link Road. Representative Viewpoint 3: Photowire
- Figure 18.36 Sizewell Link Road. Representative Viewpoint 6: Existing View
- Figure 18.37 Sizewell Link Road. Representative Viewpoint 6: Photowire
- Figure 18.38 Sizewell Link Road. Representative Viewpoint 7: Existing View
- Figure 18.39 Sizewell Link Road. Representative Viewpoint 7: Photowire
- Figure 18.40 Sizewell Link Road. Representative Viewpoint 8: Existing View
- Figure 18.41 Sizewell Link Road. Representative Viewpoint 8: Photowire
- Figure 18.42 Illustrative Visual of Proposed Pretty Road Overbridge

PART 6 OF 7

- Figure 18.43 Two Village Bypass oLEMP Plate 4.1. Proposed oLEMP Figure Habitat Typology
- Figure 18.44 Two Village Bypass oLEMP. Woodland Corridors and Linkages

Figure 18.45	Figure 18.46: Two Village Bypass. Representative Viewpoint 1: Existing View
Figure 18.46	Two Village Bypass. Representative Viewpoint 1: Photowire
Figure 18.47	Two Village Bypass. Representative Viewpoint 6: Existing View
Figure 18.48	Two Village Bypass. Representative Viewpoint 6: Photowire
Figure 18.49	Two Village Bypass. Representative Viewpoint 7: Existing View
Figure 18.50	Two Village Bypass. Representative Viewpoint 7: Photowire
Figure 18.51	Southern Park and Ride. Representative Viewpoint 9: Photograph Panel
Figure 18.52	Southern Park and Ride. Representative Viewpoint 10: Photograph Panel
Figure 18.53	Green Rail Route. Representative Viewpoint 5: Existing View
Figure 18.54	Green Rail Route. Representative Viewpoint 5: Photowire
Figure 18.55	Proposed Location for Ballast Stockpiling

PART 7 OF 7

Chapter 21

Figure 21.1	Landscape and Visual Receptor Groups within the Yoxford Community Area
-------------	--

Chapter 24

Figure 24.1	Movement Framework Phase 1
Figure 24.2	Movement Framework Phase 2-5
Figure 24.3	Movement Framework Operational



NOTES:

KEY:

NOT PROTECTIVELY MARKED

COPYRIGHT:
Reproduced from Ordnance Survey map with the permission of Ordnance Survey on behalf of the controller of Her Majesty's Stationery Office © Crown copyright (2021). All Rights reserved. NNB GenCo Licence: 0100060408



DOCUMENT:
SIZEWELL C PROJECT
RESPONSES TO EXAMINING AUTHORITY'S
WRITTEN QUESTIONS ISSUED ON 21ST APRIL 2021
CHAPTER 15: LANDSCAPE IMPACT
VISUAL EFFECTS AND DESIGN

DRAWING TITLE:
EXAMPLE PHOTOGRAPHS OF FINISH
AND APPEARANCE OF PLINTH -
TERMINAL 2B BUILDING, HEATHROW

DRAWING NO:
FIGURE 18.16

DATE:	DRAWN:	SCALE:	REV:
JUNE 2021	SB	N/A	01

SCALE BAR:

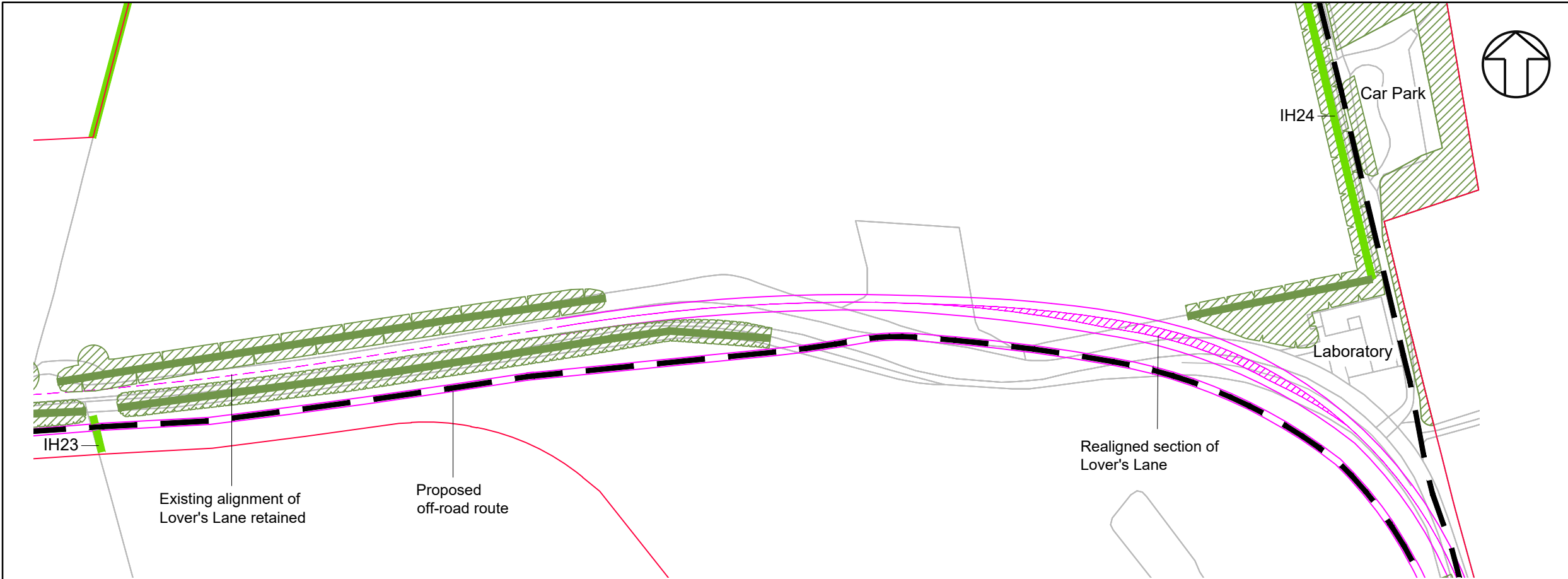



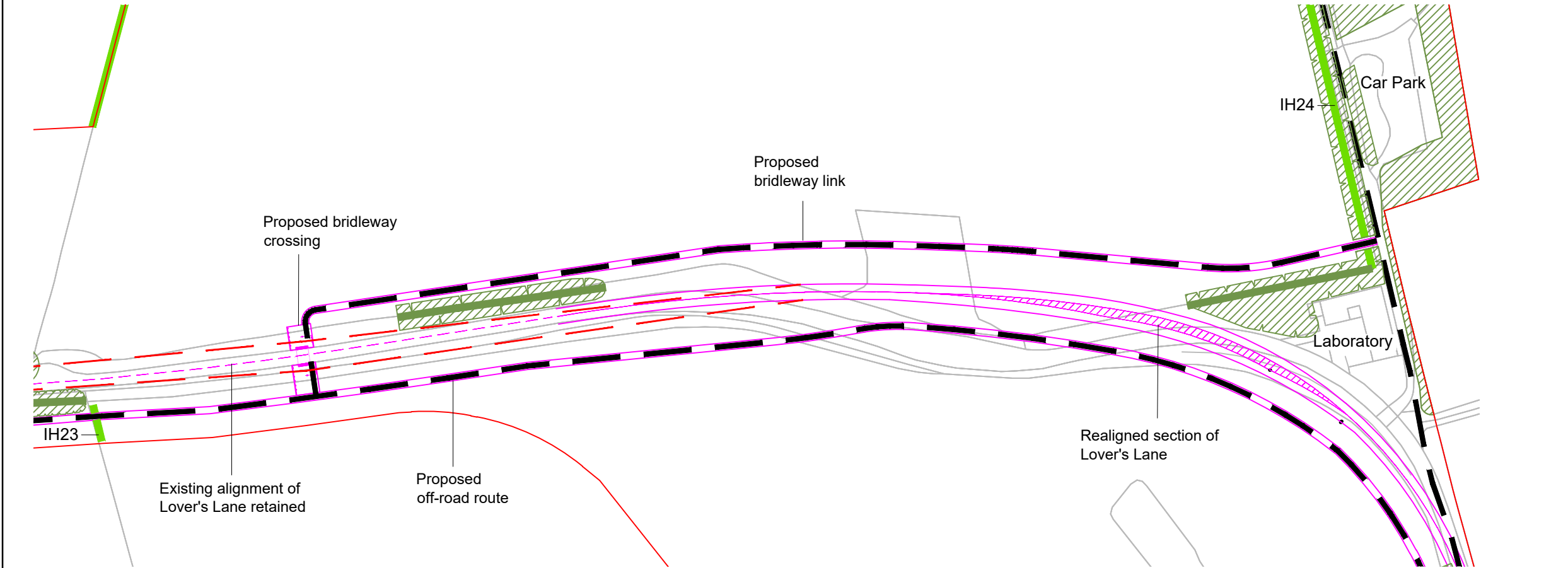

DCO Rev 01

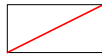

DCO Rev 02

NOTES

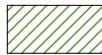
KEY

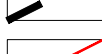
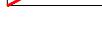
-  Sizewell C Main Development Site Boundary
-  Important hedgerow including hedgerow trees (Hedgerows Regulations 1997) to be retained
-  Other hedgerow including hedgerow trees to be retained
-  Mixed woodland / trees to be retained
-  Proposed road and footpath alignment
-  Public Right of Way (existing and proposed)
-  Crossing Sightline

NOT PROTECTIVELY MARKED

COPYRIGHT
Reproduced from Ordnance Survey map with the permission of Ordnance Survey on behalf of the controller of Her Majesty's Stationery Office © Crown Copyright (2021). All Rights reserved. NNB GenCo 0100060408.



DOCUMENT:
RESPONSES TO EXAMINING AUTHORITY'S
WRITTEN QUESTIONS ISSUED ON 21ST APRIL
2021

CHAPTER 18



DRAWING TITLE:
BRIDLEWAY LINK
COMPARISON OF REV 01 AND REV 02
LANDSCAPE RETENTION

DRAWING NO:
FIGURE 18.17

DATE:	DRAWN:	SCALE :	REVISION:
JUNE 2021	LDA	NTS	1.0

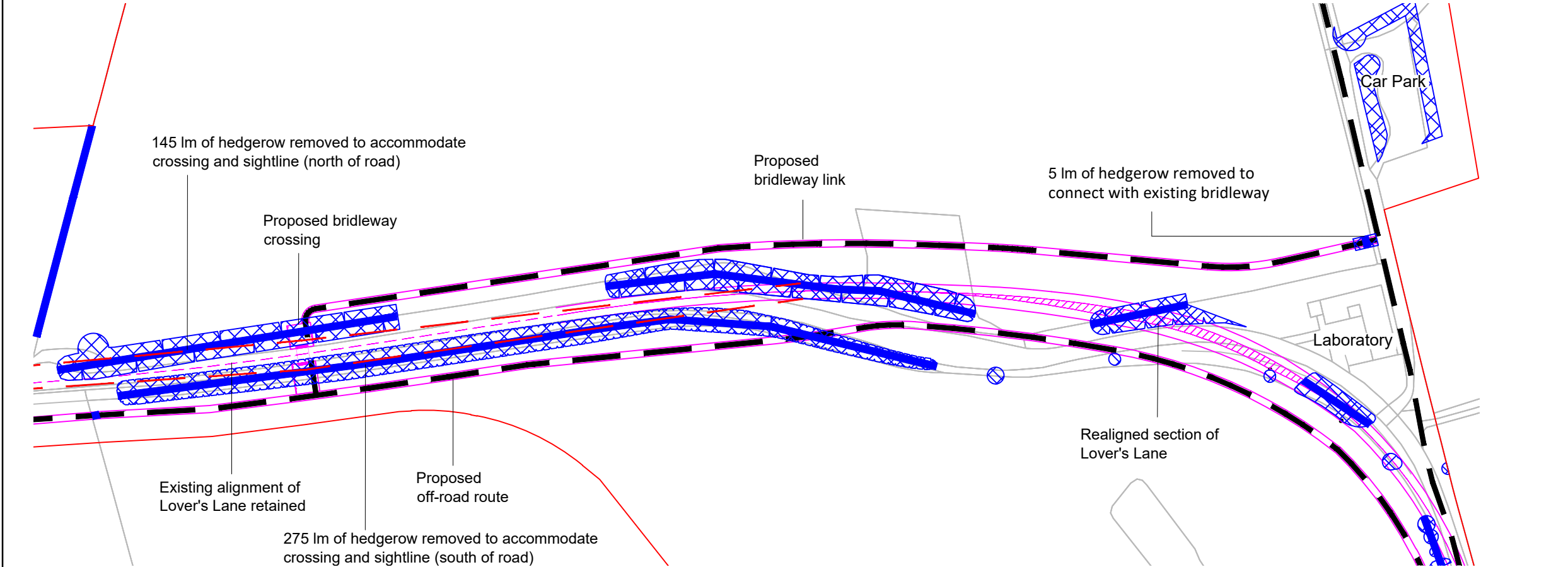
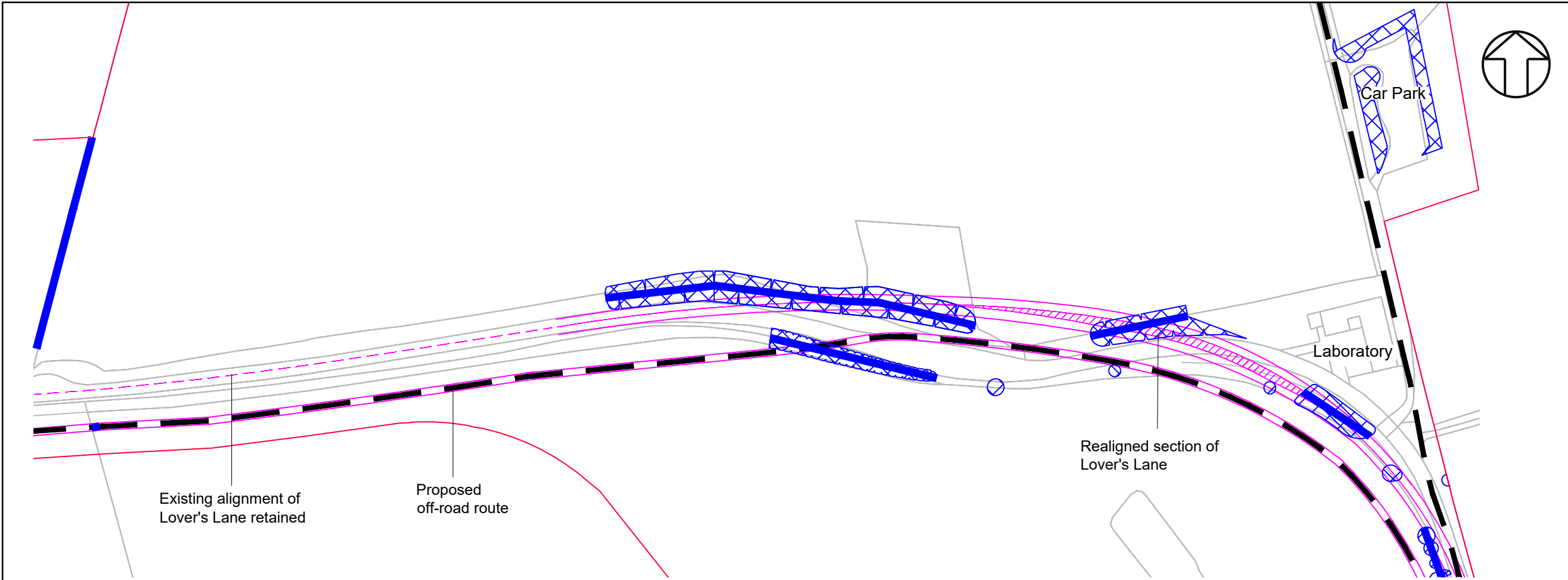
SCALE BAR
NTS



NOT PROTECTIVELY MARKED			
COPYRIGHT Reproduced from Ordnance Survey map with the permission of Ordnance Survey on behalf of the controller of Her Majesty's Stationery Office © Crown Copyright (2021). All Rights reserved. NNB GenCo 0100060408.			
 Doing the power of good for Britain  			
DOCUMENT: RESPONSES TO EXAMINING AUTHORITY'S WRITTEN QUESTIONS ISSUED ON 21ST APRIL 2021			
CHAPTER 18			
DRAWING TITLE: BRIDLEWAY LINK COMPARISON OF REV 01 AND REV 02 SITE CLEARANCE			
DRAWING NO: FIGURE 18.18			
DATE: JUNE 2021	DRAWN: LDA	SCALE : NTS	REVISION: 1.0
SCALE BAR NTS			

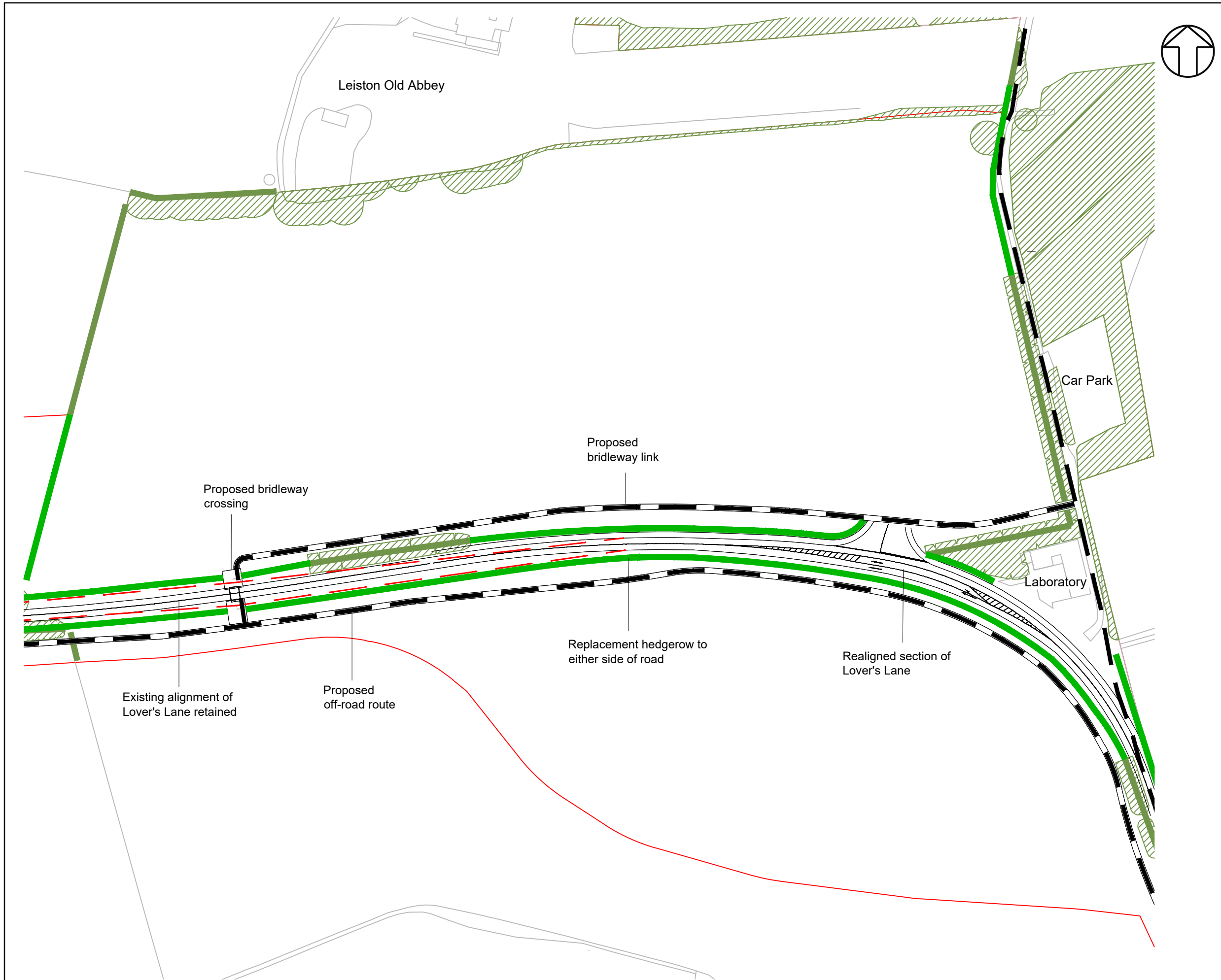

NOTES

KEY

	Sizewell C Main Development Site Boundary
	Existing hedgerow including hedgerow trees
	Proposed hedgerow
	Existing mixed woodland / trees
	Public Right of Way (existing and proposed)
	Crossing Sightlines

NOT PROTECTIVELY MARKED

COPYRIGHT
Reproduced from Ordnance Survey map with the permission of Ordnance Survey on behalf of the controller of Her Majesty's Stationery Office © Crown Copyright (2021). All Rights reserved. NNB GenCo 0100060408.

Doing the power of good for Britain

DOCUMENT:
RESPONSES TO EXAMINING AUTHORITY'S
WRITTEN QUESTIONS ISSUED ON 21ST APRIL
2021

CHAPTER 18

DRAWING TITLE:
BRIDLEWAY LINK
COMPARISON OF REV 01 AND REV 02
OPERATIONAL PHASE

DRAWING NO:
FIGURE 18.19

DATE: JUNE 2021	DRAWN: LDA	SCALE : NTS	REVISION: 1.0
--------------------	---------------	----------------	------------------

SCALE BAR
NTS

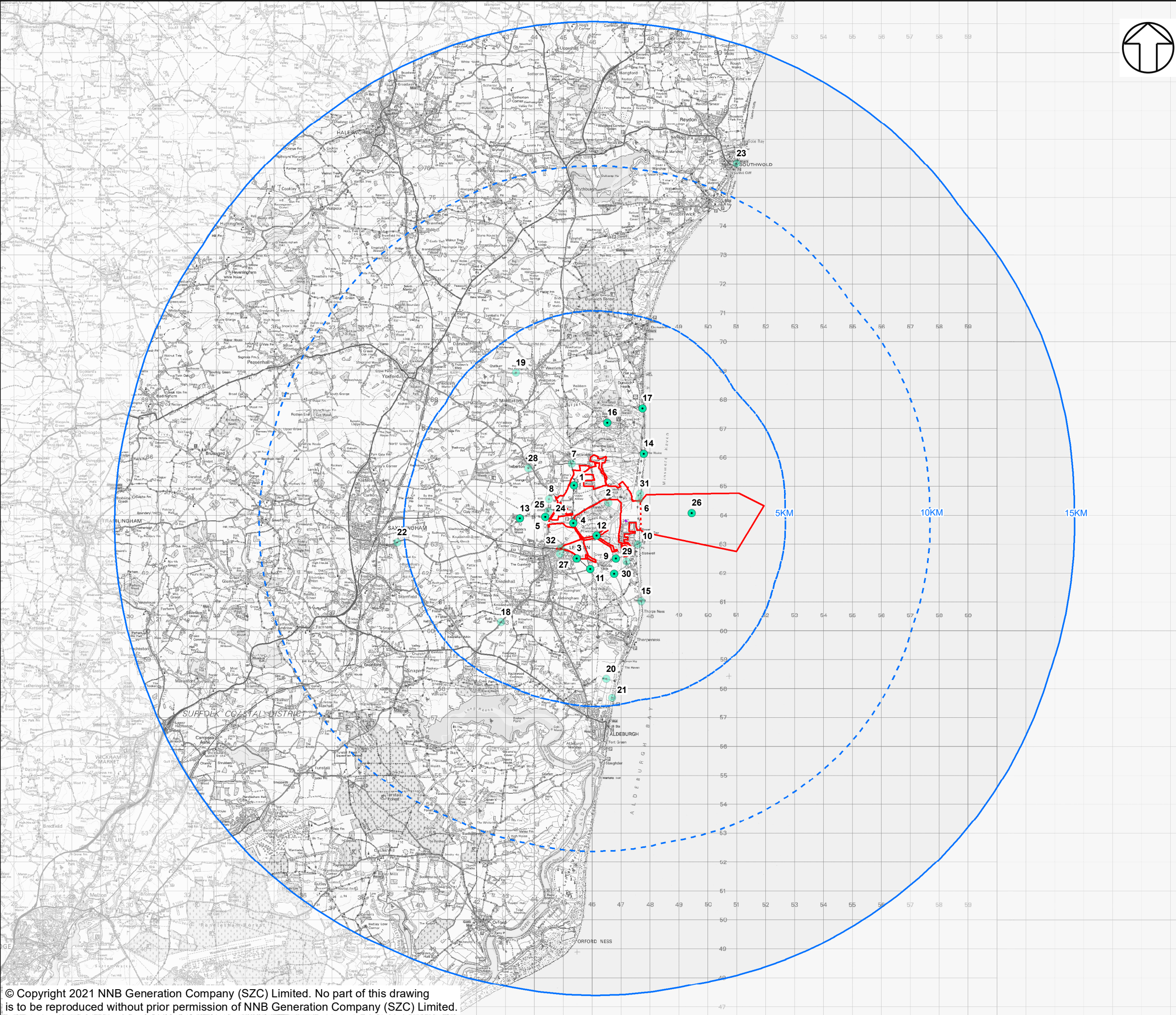

NOTES

THIS DRAWING IS BASED UPON COMPUTER GENERATED ZONE OF THEORETICAL VISIBILITY (ZTV) STUDIES PRODUCED USING THE VIEWSHED ROUTINE IN THE ESRI ARCGIS SUITE. THE AREAS SHOWN ARE THE MAXIMUM THEORETICAL VISIBILITY, TAKING INTO ACCOUNT TOPOGRAPHY, WOODLANDS, MAJOR HEDGEROWS AND BUILDINGS WHICH HAVE BEEN INCLUDED IN THE MODEL WITH THE HEIGHTS OBTAINED FROM LIDAR AND NEXTMAP 25 DIGITAL SURFACE DATA. DUE TO ITS RESOLUTION, THE SURFACE MODEL DOES NOT TAKE INTO ACCOUNT EVERY LOCALISED FEATURE SUCH AS WALLS, SMALL HEDGEROWS OR SMALL TREES AND THEREFORE ONLY GIVES AN IMPRESSION OF THE EXTENT OF VISIBILITY. THE ZTV INCLUDES AN ADJUSTMENT THAT ALLOWS FOR EARTH'S CURVATURE AND LIGHT REFRACTION. IT IS BASED ON SURFACE MODEL TERRAIN WITH A 20M² RESOLUTION. FOR DETAILS OF THE PARAMETERS INCLUDED IN THE ZTV MODEL REFER TO VOLUME 2 MAIN DEVELOPMENT SITE, CHAPTER 3 DESCRIPTION OF CONSTRUCTION OF SIZEWELL C.

KEY

- SIZEWELL C MAIN DEVELOPMENT SITE BOUNDARY
- DEMARCATION LINE
- LVIA STUDY AREA (15KM BUFFER OF MAIN DEVELOPMENT SITE – ONSHORE)
- 5KM AND 10KM BUFFERS OF MAIN DEVELOPMENT SITE – ONSHORE
- OPERATIONAL PARAMETER - P5
- REPRESENTATIVE VIEWPOINT LOCATIONS FROM WHERE THE REDUCTION IN HEIGHT OF THE SOUTHERNMOST PYLON WOULD BE VISIBLE
- REPRESENTATIVE VIEWPOINT LOCATIONS FROM WHERE THE REDUCTION IN HEIGHT OF THE SOUTHERNMOST PYLON WOULD NOT BE VISIBLE

NOT PROTECTIVELY MARKED

COPYRIGHT
Reproduced from Ordnance Survey map with the permission of Ordnance Survey on behalf of the controller of Her Majesty's Stationary Office © Crown Copyright (2021). All Rights reserved. NNB GenCo 0100060408.



DOCUMENT:
SIZEWELL C PROJECT
RESPONSES TO EXAMINING AUTHORITY'S
WRITTEN QUESTIONS ISSUED ON
21ST APRIL 2021
CHAPTER 18: LANDSCAPE IMPACT, VISUAL
EFFECTS AND DESIGN

DRAWING TITLE:
VISIBILITY OF CHANGE TO HEIGHT OF
OPERATIONAL PARAMETER P5

DRAWING NO:
FIGURE 18.20

DATE: MAY 2021 **DRAWN:** S.G. **SCALE:** 1:125,000 @A3

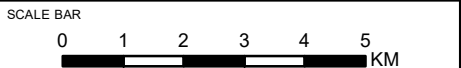



© Copyright 2020 NNB Generation Company (SZC) Limited. No part of this drawing is to be reproduced without prior permission of NNB Generation Company (SZC) Limited.

View flat at a comfortable arm's length

CAMERA LOCATION (OS GRID REFERENCE):	624428 E 240399 N	HORIZONTAL FIELD OF VIEW: 53.5° (PLANAR PROJECTION)	PHOTO DATE / TIME:	02/03/2019 14:50	NO DIMENSIONS ARE TO BE SCALED FROM THIS DRAWING, ALL DIMENSIONS ARE TO BE CHECKED ON SITE. AREA MEASUREMENTS FOR INDICATIVE PURPOSES ONLY.			COPYRIGHT Reproduced from Ordnance Survey map with the permission of Ordnance Survey on behalf of the controller of Her Majesty's Stationery Office © Crown Copyright (2019). All Rights reserved. NNB GenCo 0100060408.	DOCUMENT: SIZEWELL C PROJECT RESPONSES TO EXAMINING AUTHORITY'S WRITTEN QUESTIONS ISSUED 21ST APRIL 2021 CHAPTER 18: LANDSCAPE IMPACT, VISUAL EFFECTS AND DESIGN	DRAWING TITLE: FREIGHT MANAGEMENT FACILITY REPRESENTATIVE VIEWPOINT 1: EXISTING VIEW	NOT PROTECTIVELY MARKED			
GROUND LEVEL (MAOD):	28M	PAPER SIZE:	841MM X 297MM (HALF A1)	CAMERA MODEL AND SENSOR FORMAT:							CANON EOS 5D MARK III	DRAWING NO: FIGURE 18.21		
DIRECTION OF VIEW: BEARING FROM NORTH (0°):	297°	ENLARGEMENT FACTOR:	TBC	LENS MAKE, MODEL AND FOCAL LENGTH:							SIGMA 50MM F1.4 EX DG HSM	DATE:	DRAWN:	SCALE:
DISTANCE TO SITE:	343M	VISUALISATION TYPE:	TYPE 3	HEIGHT OF CAMERA LENS ABOVE GROUND (MAOD):							1.5M	JUNE 2021	R.K.	NTS

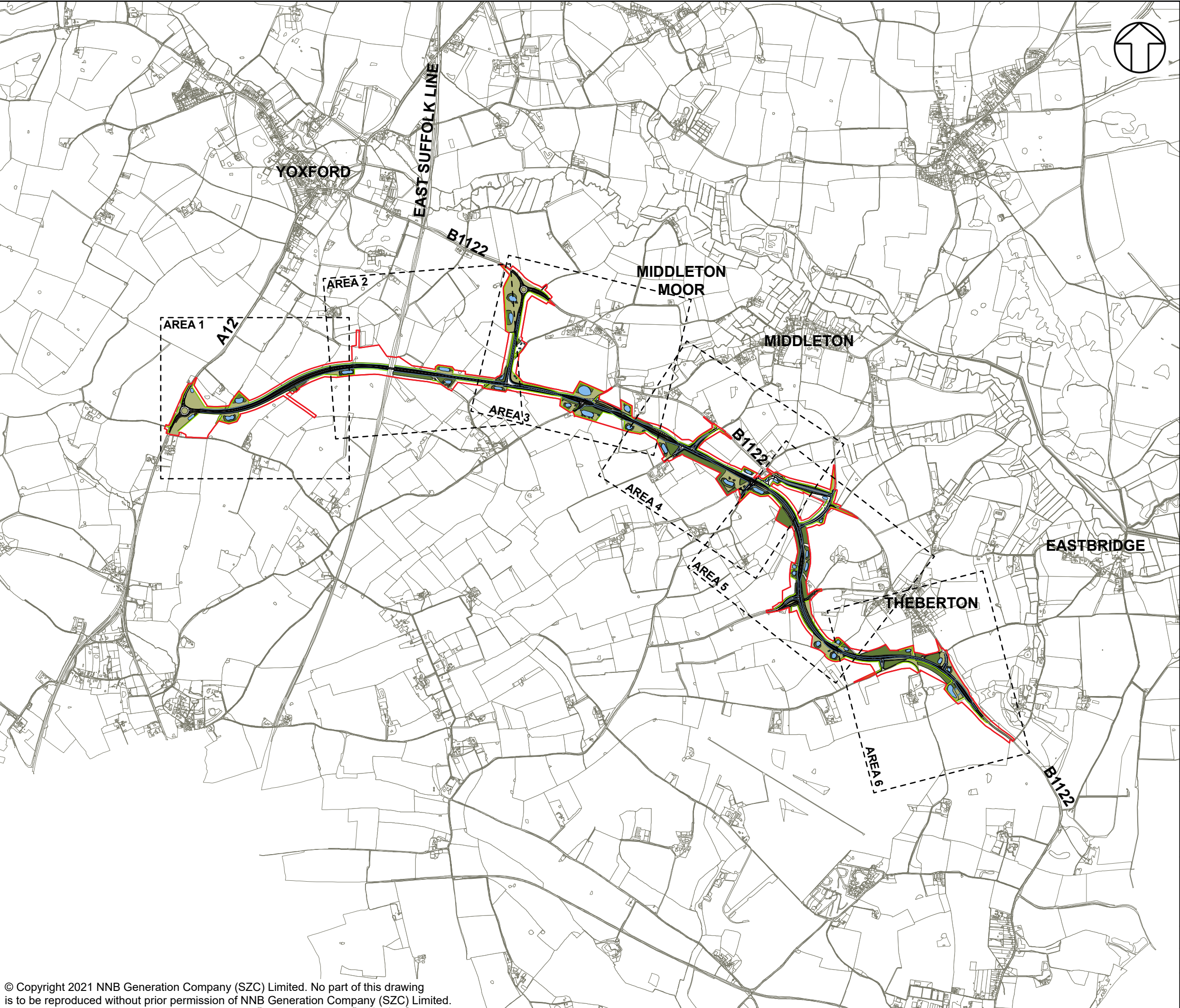

NOTES

KEY

- SIZEWELL LINK ROAD DEVELOPMENT
- SITE BOUNDARY
- BROADLEAVED WOODLAND
- SCATTERED TREES
- NATIVE HEDGEROW
- GRASSLAND
- RETAINED POND
- INDICATIVE POND
- INDICATIVE ATTENUATION BASIN
- INDICATIVE WATERCOURSE DIVERSION
- INDICATIVE SWALE

NOT PROTECTIVELY MARKED

COPYRIGHT
Reproduced from Ordnance Survey map with the permission of Ordnance Survey on behalf of the controller of Her Majesty's Stationery Office © Crown Copyright (2021). All Rights reserved. NNB GenCo 0100060408.
Esri, DigitalGlobe, GeoEye, Earthstar Geographics, CNES/Airbus DS, USDA, USGS, AeroGRID, IGN, and the GIS User Community.
PROW data sourced from Suffolk CC on 27/02/2019 under OGL v3.0 are an interpretation of the Definitive Map and Statement, not the Definitive Map itself, and should not be relied on for determining the position or alignment of any public right of way. The data contains Ordnance Survey data © Crown copyright and database right 2019.



DOCUMENT:
SIZEWELL C PROJECT
RESPONSES TO EXAMINING AUTHORITY'S
WRITTEN QUESTIONS ISSUED 21ST APRIL 2021
CHAPTER 18: LANDSCAPE IMPACT, VISUAL
EFFECTS AND DESIGN

DRAWING TITLE:
SIZEWELL LINK ROAD OUTLINE LANDSCAPE AND
ECOLOGY MANAGEMENT PLAN
PLATE 4.1 - PROPOSED OLEMP HABITAT
TYPOLOGY – OVERVIEW

DRAWING NO:
FIGURE 18.24

DATE: JUNE 2021 **DRAWN:** V.W. **SCALE:** 1:25,000 @A3

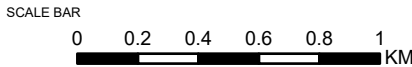

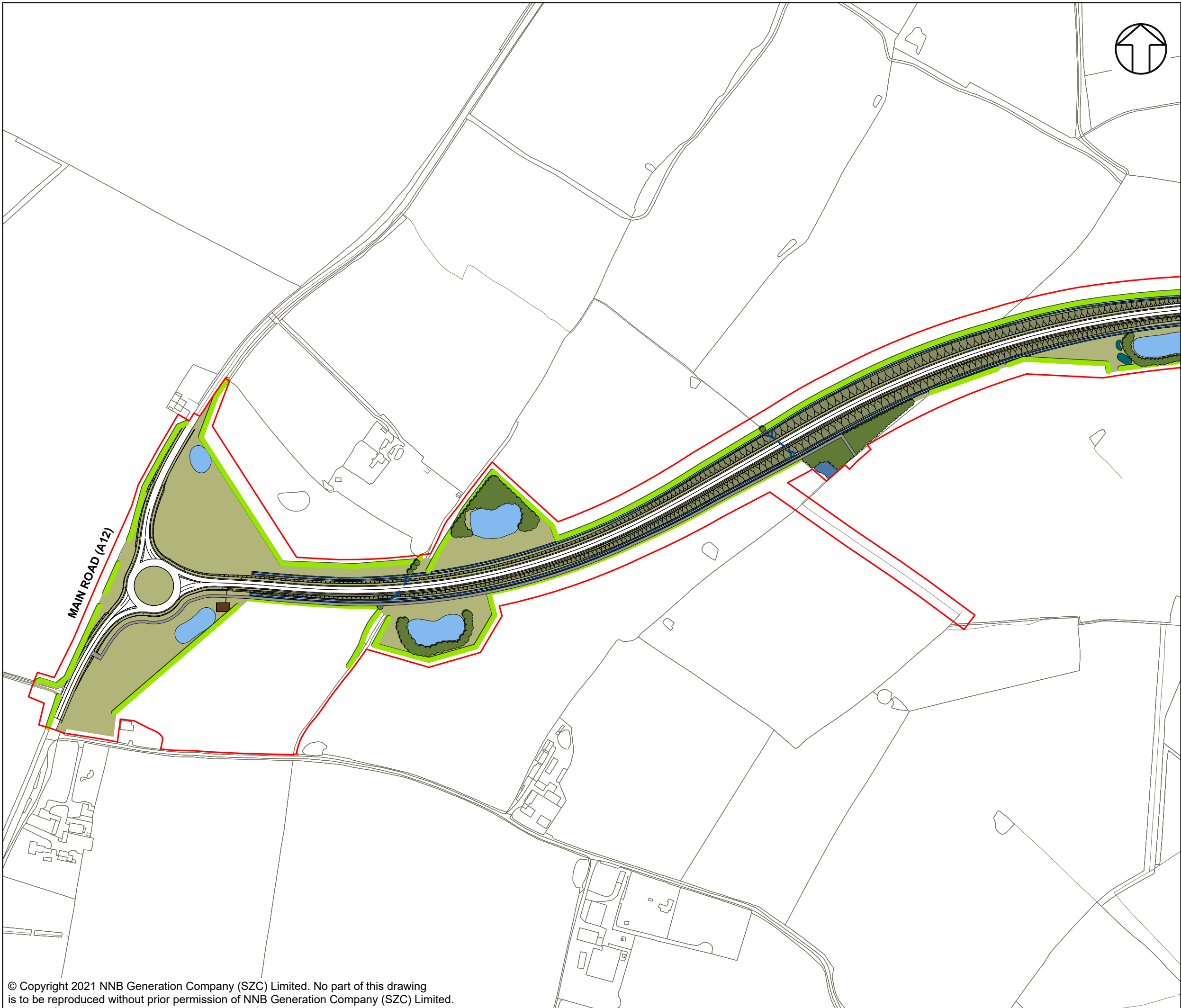

NOTES

KEY

- SIZEWELL LINK ROAD DEVELOPMENT SITE BOUNDARY
- BROADLEAVED WOODLAND
- SCATTERED TREES
- NATIVE HEDGEROW
- GRASSLAND
- RETAINED POND
- INDICATIVE POND
- INDICATIVE ATTENUATION BASIN
- INDICATIVE WATERCOURSE DIVERSION
- INDICATIVE SWALE

NOT PROTECTIVELY MARKED

COPYRIGHT

Reproduced from Ordnance Survey map with the permission of Ordnance Survey on behalf of the controller of Her Majesty's Stationery Office © Crown Copyright (2021). All Rights reserved. NNB GenCo 0100060408.
Esri, DigitalGlobe, GeoEye, Earthstar Geographics, CNES/Airbus DS, USDA, USGS, AeroGRID, IGN, and the GIS User Community.
PROW data sourced from Suffolk CC on 27/02/2019 under OGL v3.0 are an interpretation of the Definitive Map and Statement, not the Definitive Map itself, and should not be relied on for determining the position or alignment of any public right of way. The data contains Ordnance Survey data © Crown copyright and database right 2019.



DOCUMENT:
SIZEWELL C PROJECT
RESPONSES TO EXAMINING AUTHORITY'S
WRITTEN QUESTIONS ISSUED 21ST APRIL 2021
CHAPTER 18: LANDSCAPE IMPACT, VISUAL
EFFECTS AND DESIGN

DRAWING TITLE:
SIZEWELL LINK ROAD OUTLINE LANDSCAPE AND
ECOLOGY MANAGEMENT PLAN
PLATE 4.2 - PROPOSED OLEMP HABITAT
TYPOLOGY – AREA 1

DRAWING NO:
FIGURE 18.25

DATE: JUNE 2021 DRAWN: V.W. SCALE: 1:25,000 @A3

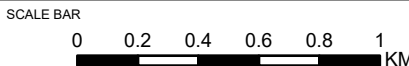

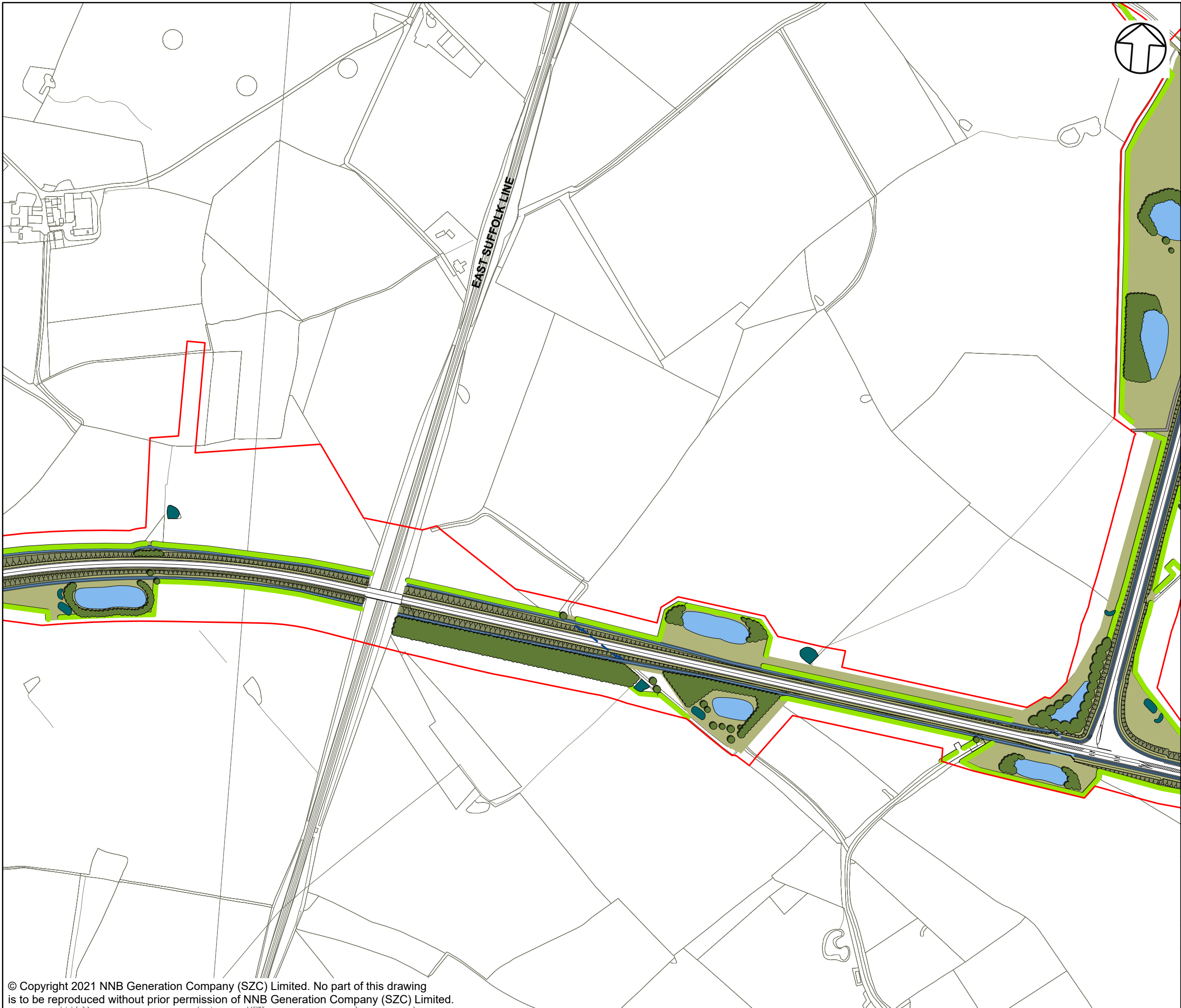

NOTES

KEY

- SIZEWELL LINK ROAD DEVELOPMENT
- SITE BOUNDARY
- BROADLEAVED WOODLAND
- SCATTERED TREES
- NATIVE HEDGEROW
- GRASSLAND
- RETAINED POND
- INDICATIVE POND
- INDICATIVE ATTENUATION BASIN
- INDICATIVE WATERCOURSE DIVERSION
- INDICATIVE SWALE

NOT PROTECTIVELY MARKED

COPYRIGHT
Reproduced from Ordnance Survey map with the permission of Ordnance Survey on behalf of the controller of Her Majesty's Stationery Office © Crown Copyright (2021). All Rights reserved. NNB GenCo 0100060408.
Esri, DigitalGlobe, GeoEye, Earthstar Geographics, CNES/Airbus DS, USDA, USGS, AeroGRID, IGN, and the GIS User Community.
PROW data sourced from Suffolk CC on 27/02/2019 under OGL v3.0 are an interpretation of the Definitive Map and Statement, not the Definitive Map itself, and should not be relied on for determining the position or alignment of any public right of way. The data contains Ordnance Survey data © Crown copyright and database right 2019.



DOCUMENT:
SIZEWELL C PROJECT
RESPONSES TO EXAMINING AUTHORITY'S
WRITTEN QUESTIONS ISSUED 21ST APRIL 2021
CHAPTER 18: LANDSCAPE IMPACT, VISUAL
EFFECTS AND DESIGN

DRAWING TITLE:
SIZEWELL LINK ROAD OUTLINE LANDSCAPE AND
ECOLOGY MANAGEMENT PLAN
PLATE 4.3 - PROPOSED OLEMP HABITAT
TYPOLOGY – AREA 2

DRAWING NO:
FIGURE 18.26

DATE: JUNE 2021	DRAWN: V.W.	SCALE: 1:25,000 @A3
---------------------------	-----------------------	-------------------------------

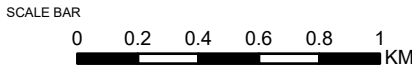

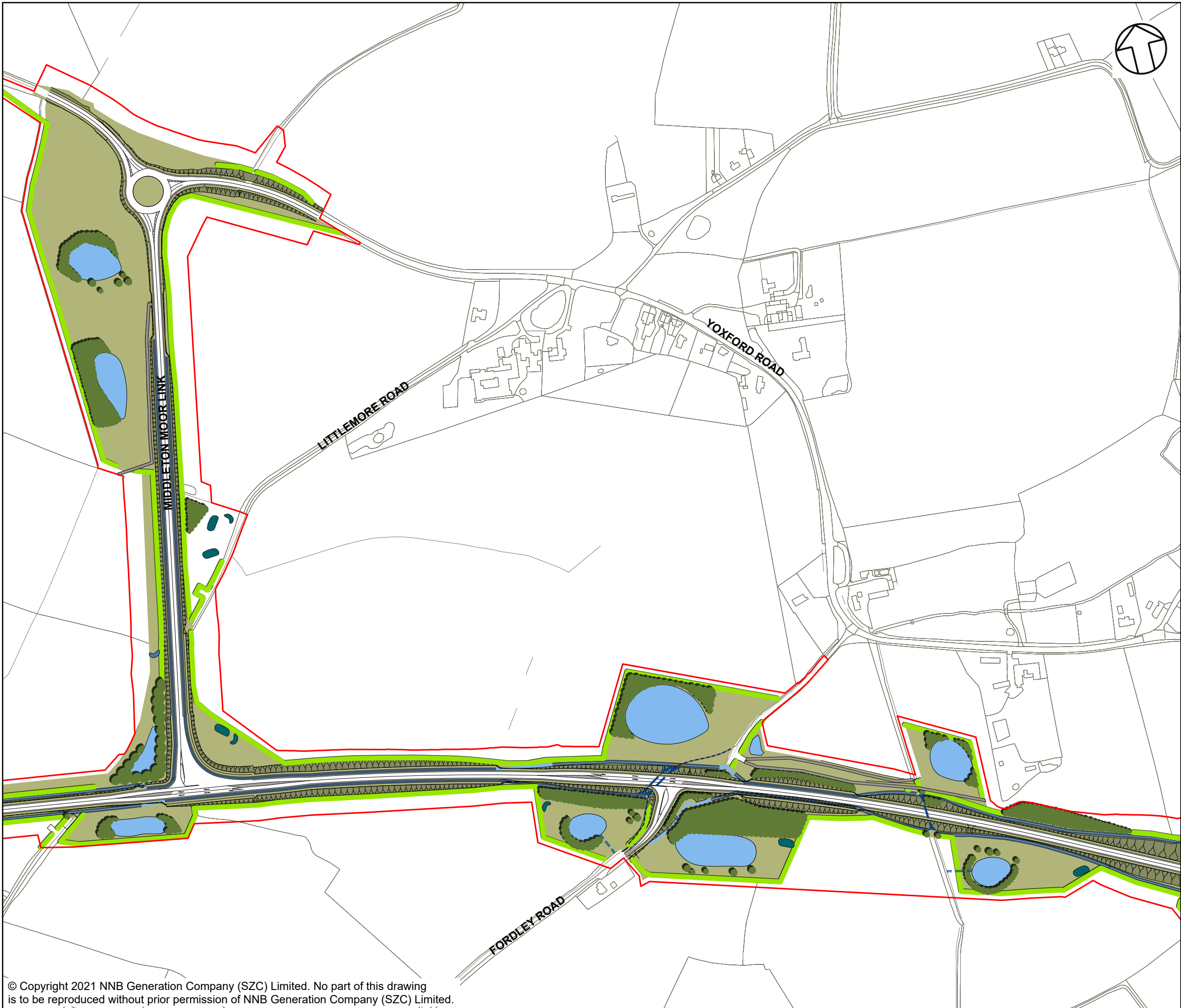

NOTES

KEY

- SIZEWELL LINK ROAD DEVELOPMENT
- SITE BOUNDARY
- BROADLEAVED WOODLAND
- SCATTERED TREES
- NATIVE HEDGEROW
- GRASSLAND
- RETAINED POND
- INDICATIVE POND
- INDICATIVE ATTENUATION BASIN
- INDICATIVE WATERCOURSE DIVERSION
- INDICATIVE SWALE

NOT PROTECTIVELY MARKED

COPYRIGHT
Reproduced from Ordnance Survey map with the permission of Ordnance Survey on behalf of the controller of Her Majesty's Stationery Office © Crown Copyright (2021). All Rights reserved. NNB GenCo 0100060408.
Esri, DigitalGlobe, GeoEye, Earthstar Geographics, CNES/Airbus DS, USDA, USGS, AeroGRID, IGN, and the GIS User Community.
PROW data sourced from Suffolk CC on 27/02/2019 under OGL v3.0 are an interpretation of the Definitive Map and Statement, not the Definitive Map itself, and should not be relied on for determining the position or alignment of any public right of way. The data contains Ordnance Survey data © Crown copyright and database right 2019.



DOCUMENT:
SIZEWELL C PROJECT
RESPONSES TO EXAMINING AUTHORITY'S
WRITTEN QUESTIONS ISSUED 21ST APRIL 2021
CHAPTER 18: LANDSCAPE IMPACT, VISUAL
EFFECTS AND DESIGN

DRAWING TITLE:
SIZEWELL LINK ROAD OUTLINE LANDSCAPE AND
ECOLOGY MANAGEMENT PLAN
PLATE 4.4 - PROPOSED OLEMP HABITAT
TYPOLOGY – AREA 3

DRAWING NO:
FIGURE 18.27

DATE: JUNE 2021	DRAWN: V.W.	SCALE: 1:25,000 @A3
---------------------------	-----------------------	-------------------------------

SCALE BAR
0 0.2 0.4 0.6 0.8 1 KM

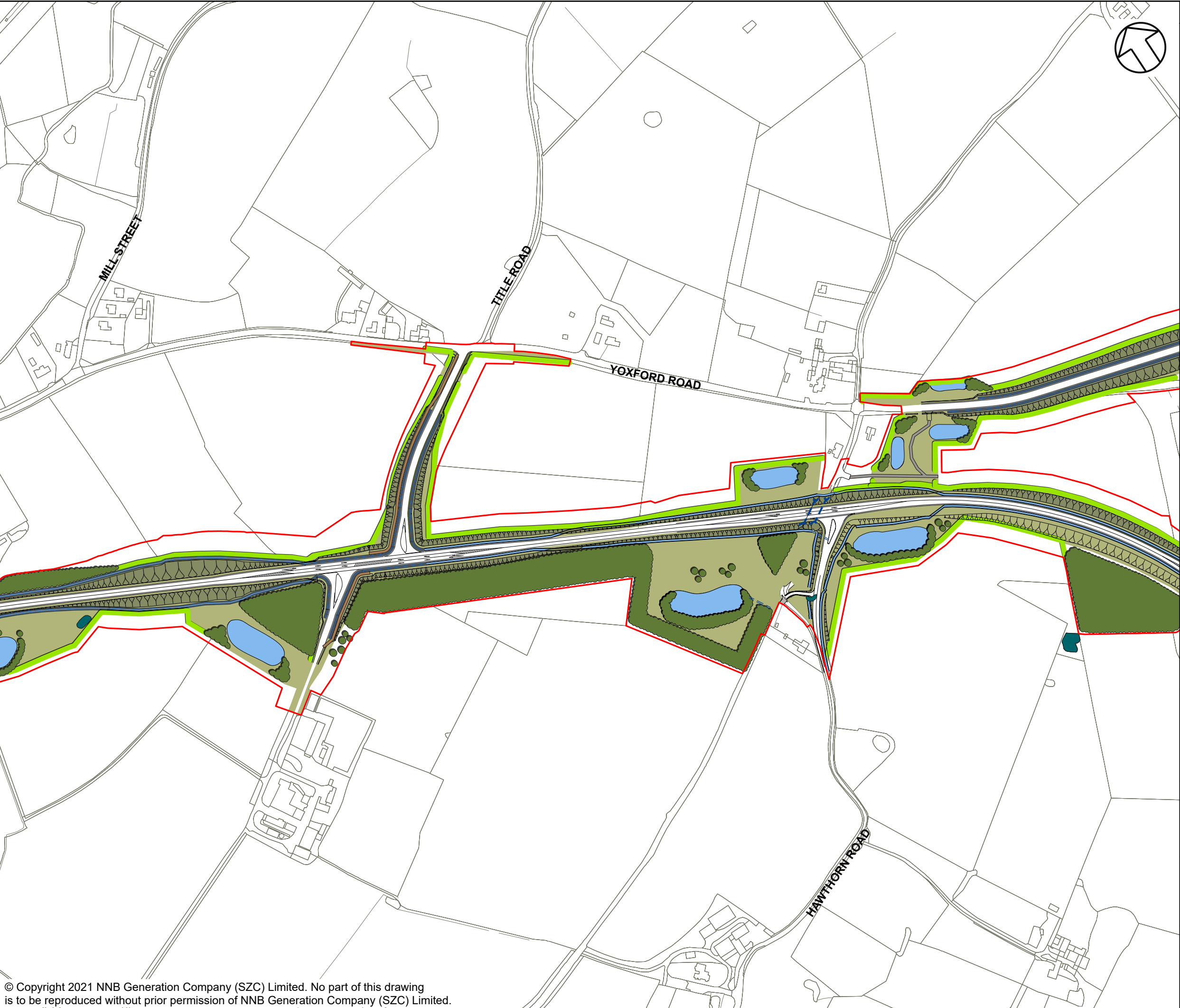

NOTES

KEY

- SIZEWELL LINK ROAD DEVELOPMENT
- SITE BOUNDARY
- BROADLEAVED WOODLAND
- SCATTERED TREES
- NATIVE HEDGEROW
- GRASSLAND
- RETAINED POND
- INDICATIVE POND
- INDICATIVE ATTENUATION BASIN
- INDICATIVE WATERCOURSE DIVERSION
- INDICATIVE SWALE

NOT PROTECTIVELY MARKED

COPYRIGHT
Reproduced from Ordnance Survey map with the permission of Ordnance Survey on behalf of the controller of Her Majesty's Stationery Office © Crown Copyright (2021). All Rights reserved. NNB GenCo 0100060408.
Esri, DigitalGlobe, GeoEye, Earthstar Geographics, CNES/Airbus DS, USDA, USGS, AeroGRID, IGN, and the GIS User Community.
PROW data sourced from Suffolk CC on 27/02/2019 under OGL v3.0 are an interpretation of the Definitive Map and Statement, not the Definitive Map itself, and should not be relied on for determining the position or alignment of any public right of way. The data contains Ordnance Survey data © Crown copyright and database right 2019.



DOCUMENT:
SIZEWELL C PROJECT
RESPONSES TO EXAMINING AUTHORITY'S
WRITTEN QUESTIONS ISSUED 21ST APRIL 2021
CHAPTER 18: LANDSCAPE IMPACT, VISUAL
EFFECTS AND DESIGN

DRAWING TITLE:
SIZEWELL LINK ROAD OUTLINE LANDSCAPE AND
ECOLOGY MANAGEMENT PLAN
PLATE 4.5 - PROPOSED OLEMP HABITAT
TYPOLOGY – AREA 4

DRAWING NO:
FIGURE 18.28

DATE: JUNE 2021	DRAWN: V.W.	SCALE: 1:25,000 @A3
--------------------	----------------	------------------------

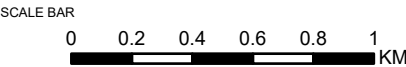

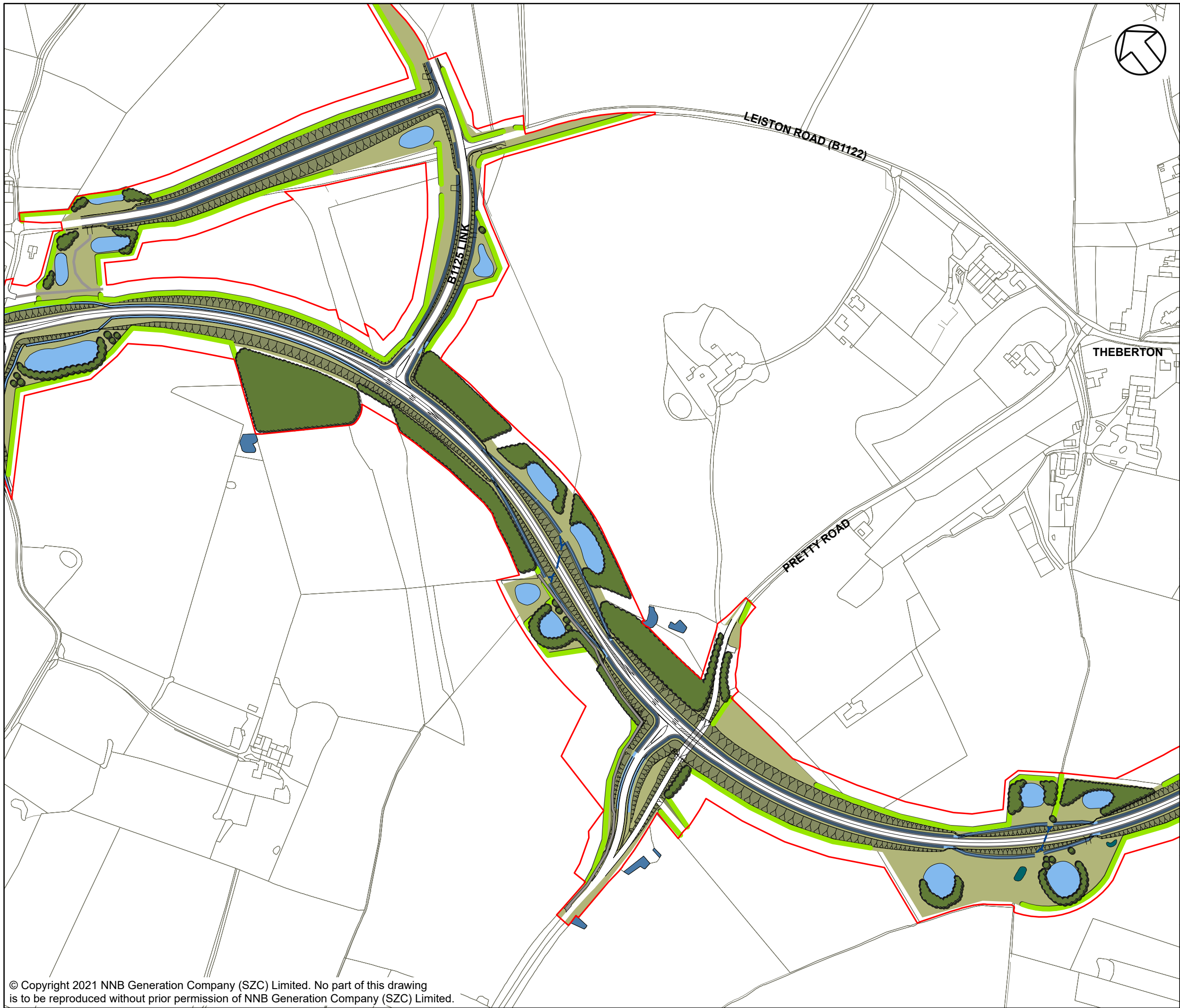

NOTES

KEY

- SIZEWELL LINK ROAD DEVELOPMENT
- SITE BOUNDARY
- BROADLEAVED WOODLAND
- SCATTERED TREES
- NATIVE HEDGEROW
- GRASSLAND
- RETAINED POND
- INDICATIVE POND
- INDICATIVE ATTENUATION BASIN
- INDICATIVE WATERCOURSE DIVERSION
- INDICATIVE SWALE

NOT PROTECTIVELY MARKED

COPYRIGHT

Reproduced from Ordnance Survey map with the permission of Ordnance Survey on behalf of the controller of Her Majesty's Stationery Office © Crown Copyright (2021). All Rights reserved. NNB GenCo 0100060408.
Esri, DigitalGlobe, GeoEye, Earthstar Geographics, CNES/Airbus DS, USDA, USGS, AeroGRID, IGN, and the GIS User Community.
PROW data sourced from Suffolk CC on 27/02/2019 under OGL v3.0 are an interpretation of the Definitive Map and Statement, not the Definitive Map itself, and should not be relied on for determining the position or alignment of any public right of way. The data contains Ordnance Survey data © Crown copyright and database right 2019.



DOCUMENT:
SIZEWELL C PROJECT
RESPONSES TO EXAMINING AUTHORITY'S
WRITTEN QUESTIONS ISSUED 21ST APRIL 2021
CHAPTER 18: LANDSCAPE IMPACT, VISUAL
EFFECTS AND DESIGN

DRAWING TITLE:
SIZEWELL LINK ROAD OUTLINE LANDSCAPE AND
ECOLOGY MANAGEMENT PLAN
PLATE 4.6 - PROPOSED OLEMP HABITAT
TYPOLOGY – AREA 5

DRAWING NO:
FIGURE 18.29

DATE: JUNE 2021 DRAWN: V.W. SCALE: 1:25,000 @A3

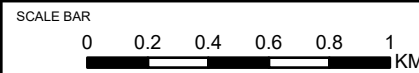



NOTES

KEY

- SIZEWELL LINK ROAD DEVELOPMENT SITE BOUNDARY
- BROADLEAVED WOODLAND
- SCATTERED TREES
- NATIVE HEDGEROW
- GRASSLAND
- RETAINED POND
- INDICATIVE POND
- INDICATIVE ATTENUATION BASIN
- INDICATIVE WATERCOURSE DIVERSION
- INDICATIVE SWALE

NOT PROTECTIVELY MARKED

COPYRIGHT
Reproduced from Ordnance Survey map with the permission of Ordnance Survey on behalf of the controller of Her Majesty's Stationery Office © Crown Copyright (2021). All Rights reserved. NNB GenCo 0100060408.
Esri, DigitalGlobe, GeoEye, Earthstar Geographics, CNES/Airbus DS, USDA, USGS, AeroGRID, IGN, and the GIS User Community.
PROW data sourced from Suffolk CC on 27/02/2019 under OGL v3.0 are an interpretation of the Definitive Map and Statement, not the Definitive Map itself, and should not be relied on for determining the position or alignment of any public right of way. The data contains Ordnance Survey data © Crown copyright and database right 2019.



DOCUMENT:
SIZEWELL C PROJECT
RESPONSES TO EXAMINING AUTHORITY'S
WRITTEN QUESTIONS ISSUED 21ST APRIL 2021
CHAPTER 18: LANDSCAPE IMPACT, VISUAL
EFFECTS AND DESIGN

DRAWING TITLE:
SIZEWELL LINK ROAD OUTLINE LANDSCAPE AND
ECOLOGY MANAGEMENT PLAN
PLATE 4.7 - PROPOSED OLEMP HABITAT
TYPOLOGY – AREA 6

DRAWING NO:
FIGURE 18.30

DATE: JUNE 2021	DRAWN: V.W.	SCALE: 1:25,000 @A3
---------------------------	-----------------------	-------------------------------

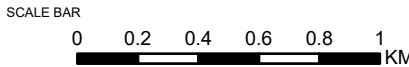



NOTES:

1. FOR DETAILS OF PERMANENT AND TEMPORARY POSSESSION WITHIN ORDER LIMITS REFER TO LAND PLANS.

KEY:

- DEVELOPMENT SITE BOUNDARY
- SOFTWORKS - EXISTING**
- RETAINED HEDGEROW
- RETAINED IMPORTANT HEDGEROW (HEDGEROW REGULATIONS 1997)
- RETAINED AND ENHANCED TREES AND SHRUBS
- RETAINED AND ENHANCED POND
- SOFTWORKS - PROPOSED**
- HEDGEROW PLANTING
- NATIVE TREE AND SHRUB PLANTING
- GRASSLAND - RETAINED OR REINSTATED
- TO BE REINSTATED UPON COMPLETION OF CONSTRUCTION WORKS
- EXISTING POND TO BE REINSTATED UPON COMPLETION OF CONSTRUCTION WORKS
- INDICATIVE POND FOR GREAT CRESTED NEWT MITIGATION
- INDICATIVE POND FOR BIODIVERSITY NET GAIN
- HARDWORKS - PROPOSED**
- HIGHWAY BOUNDARY FENCE
- VEHICLE SURFACING
- EARTHWORKS / INDICATIVE DRAINAGE - PROPOSED**
- CUTTING OR EMBANKMENT
- INDICATIVE ATTENUATION BASIN
- INDICATIVE SWALE
- PROPOSED WATERCOURSE CULVERT

NOT PROTECTIVELY MARKED

COPYRIGHT:

Reproduced from Ordnance Survey map with the permission of Ordnance Survey on behalf of the controller of Her Majesty's Stationery Office © Crown copyright (2021). All Rights reserved. NNB GenCo Licence: 0100060408



DOCUMENT:

SIZEWELL C PROJECT
RESPONSES TO EXAMINING AUTHORITY'S
WRITTEN QUESTIONS ISSUED ON 21ST APRIL 2021
CHAPTER 18: LANDSCAPE IMPACT, VISUAL
EFFECTS AND DESIGN

DRAWING TITLE:

SIZEWELL LINK ROAD OLEMP
WOODLAND PLANTING EAST OF THE EAST
SUFFOLK LINE

DRAWING NO:

FIGURE 18.31

DATE: JUNE 2021 DRAWN: R.K. SCALE: 1:2,500 REVISION: 01

SCALE BAR:

25m 0 25 50 75m



© Copyright 2020 NNB Generation Company (SZC) Limited. No part of this drawing is to be reproduced without prior permission of NNB Generation Company (SZC) Limited.

View flat at a comfortable arm's length

CAMERA LOCATION (OS GRID REFERENCE): 643470 E 265779 N		HORIZONTAL FIELD OF VIEW: 53.5° (PLANAR PROJECTION)		PHOTO DATE / TIME: 06/03/2019 10:15		<div>NO DIMENSIONS ARE TO BE SCALED FROM THIS DRAWING. ALL DIMENSIONS ARE TO BE CHECKED ON SITE. AREA MEASUREMENTS FOR INDICATIVE PURPOSES ONLY.</div> <div><div><div><div>COPYRIGHT</div><div>Reproduced from Ordnance Survey map with the permission of Ordnance Survey on behalf of the controller of Her Majesty's Stationery Office © Crown Copyright (2019). All Rights reserved. NNB GenCo 0100060408.</div></div></div></div>	DOCUMENT: SIZEWELL C PROJECT RESPONSES TO EXAMINING AUTHORITY'S WRITTEN QUESTIONS ISSUED 21ST APRIL 2021 CHAPTER 18: LANDSCAPE IMPACT, VISUAL EFFECTS AND DESIGN		DRAWING TITLE: SIZEWELL LINK ROAD REPRESENTATIVE VIEWPOINT 2: EXISTING VIEW		NOT PROTECTIVELY MARKED	
GROUND LEVEL (MAOD): 7.4M		PAPER SIZE: 841MM X 297MM (HALF A1)		CAMERA MODEL AND SENSOR FORMAT: CANON EOS 5D MARK III			DRAWING NO: FIGURE 18.32					
DIRECTION OF VIEW: BEARING FROM NORTH (0°): 209°		ENLARGEMENT FACTOR: TBC		LENS MAKE, MODEL AND FOCAL LENGTH: SIGMA 50MM F1.4 EX DG HSM			DATE: JUNE 2021		DRAWN: R.K.		SCALE: NTS	
DISTANCE TO SITE: 245M		VISUALISATION TYPE: TYPE 3		HEIGHT OF CAMERA LENS ABOVE GROUND (MAOD): 1.5M								



© Copyright 2020 NNB Generation Company (SZC) Limited. No part of this drawing is to be reproduced without prior permission of NNB Generation Company (SZC) Limited.

View flat at a comfortable arm's length

CAMERA LOCATION (OS GRID REFERENCE):	643470 E 265779 N	HORIZONTAL FIELD OF VIEW: 53.5° (PLANAR PROJECTION)	PHOTO DATE / TIME:	06/03/2019 10:15	<div>THIS VISUALISATION IS BASED UPON LIDAR DIGITAL SURFACE DATA WITH SPOT HEIGHTS AT 2M INTERVALS AND DOES NOT PRECISELY MODEL SMALL SCALE CHANGES IN LANDFORM OR SHARP BREAKS IN SLOPE.</div> <div>NO DIMENSIONS ARE TO BE SCALED FROM THIS DRAWING. ALL DIMENSIONS ARE TO BE CHECKED ON SITE.</div> <div>AREA MEASUREMENTS FOR INDICATIVE PURPOSES ONLY.</div>			<div>COPYRIGHT</div> <div>Reproduced from Ordnance Survey map with the permission of Ordnance Survey on behalf of the controller of Her Majesty's Stationery Office © Crown Copyright (2019).</div> <div>CHAPTER 18: LANDSCAPE IMPACT, VISUAL EFFECTS AND DESIGN</div>	DOCUMENT: SIZEWELL C PROJECT RESPONSES TO EXAMINING AUTHORITY'S WRITTEN QUESTIONS ISSUED 21ST APRIL 2021 CHAPTER 18: LANDSCAPE IMPACT, VISUAL EFFECTS AND DESIGN	DRAWING TITLE: SIZEWELL LINK ROAD REPRESENTATIVE VIEWPOINT 2: PHOTOWIRE	NOT PROTECTIVELY MARKED						
GROUND LEVEL (MAOD):	7.4M	PAPER SIZE:	841MM X 297MM (HALF A1)	CAMERA MODEL AND SENSOR FORMAT:							CANON EOS 5D MARK III	DRAWING NO: FIGURE 18.33					
DIRECTION OF VIEW: BEARING FROM NORTH (0°):	209°	ENLARGEMENT FACTOR:	TBC	LENS MAKE, MODEL AND FOCAL LENGTH:							SIGMA 50MM F1.4 EX DG HSM	DATE:	JUNE 2021	DRAWN:	R.K.	SCALE:	NTS
DISTANCE TO SITE:	245M	VISUALISATION TYPE:	TYPE 3	HEIGHT OF CAMERA LENS ABOVE GROUND (MAOD):							1.5M						